

# Sunnidale Trails Secondary Plan Area

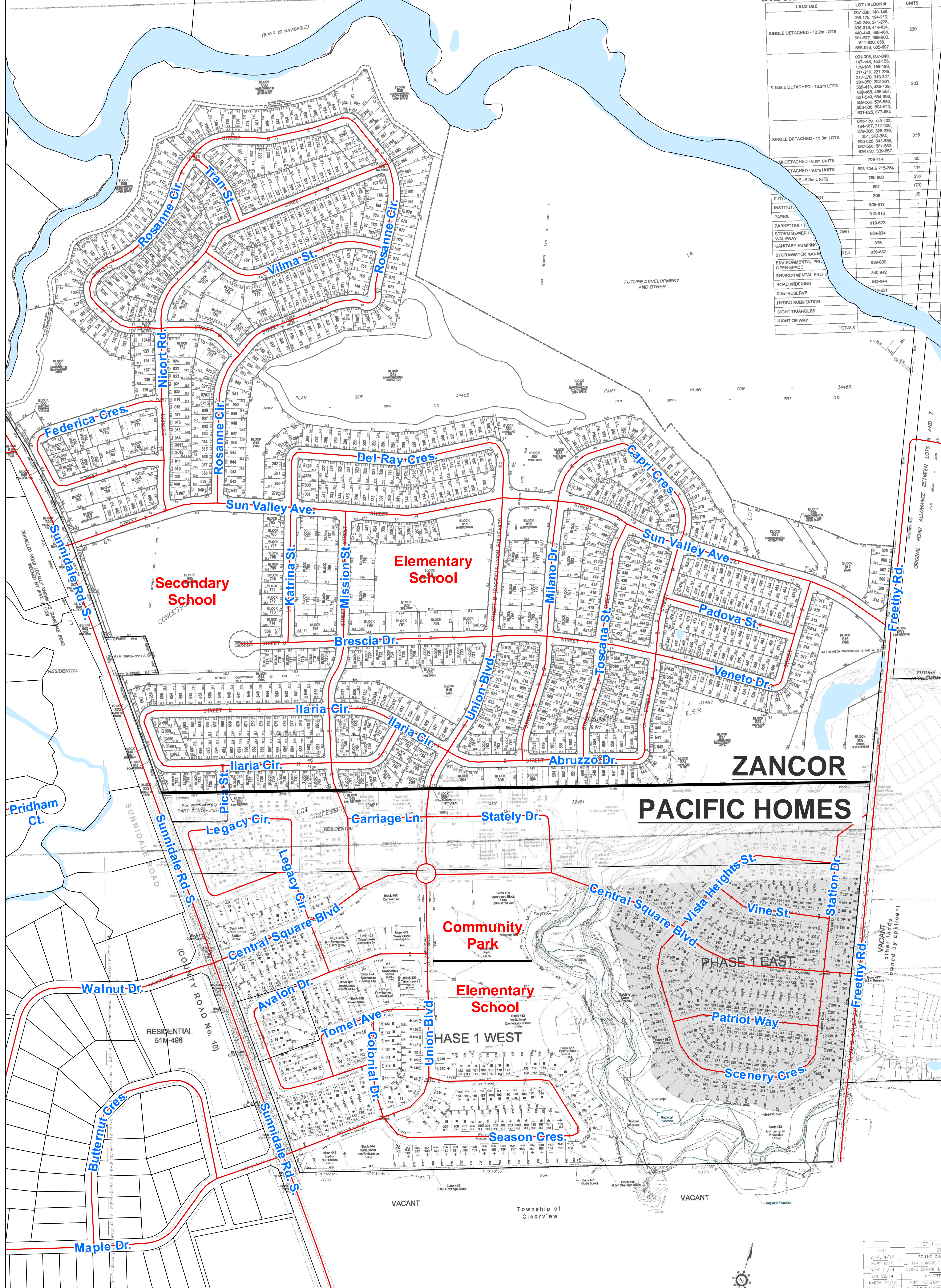

LAND USE SUMMARY		
LAND USE	LOT / BLOCK #	UNITS
SINGLE DETACHED - 12.2m LOTS	007-036, 140-146, 166-178, 184-210, 240-240, 271-278, 306-318, 414-434, 440-449, 466-484, 691-677, 668-603, 611-620, 638, 658-676, 685-697	230
SINGLE DETACHED - 13.2m LOTS	001-006, 037-040, 147-148, 153-155, 179-183, 188-193, 211-219, 221-239, 247-270, 319-327, 331-350, 352-361, 368-413, 436-439, 456-465, 485-504, 527-540, 554-556, 559-560, 576-580, 583-588, 624-610, 621-625, 677-684	232
SINGLE DETACHED - 15.3m LOTS	041-136, 149-152, 184-187, 217-220, 279-305, 329-330, 351-362-384, 505-526, 541-563, 567-568, 581-582, 626-637, 639-657	235
MINI DETACHED - 8.8m UNITS	706-714	20
DETACHED - 9.0m UNITS	698-704 & 715-764	114
DETACHED - 8.0m UNITS	765-806	236
FUTURE DEVELOPMENT AND OTHER	807	(73)
FUTURE DEVELOPMENT AND OTHER	808	(5)
INSTITUTIONAL	809-812	-
PARKS	813-818	-
PARKETTES / WALKWAY	819-823	-
STORM SEWER / WALKWAY	824-834	-
SANITARY PUMPING	835	-
STORMWATER MANAGEMENT	836-837	-
ENVIRONMENTAL PROTECTION	838-839	-
ENVIRONMENTAL PROTECTION	840-842	-
ROAD WIDENING	843-844	-
0.3m RESERVE	845-851	-
HYDRO SUBSTATION	-	-
SIGHT TRIANGLES	-	-
RIGHT OF WAY	-	-
TOTALS	-	-

DATE	BY	REVISION
APRIL 2019	SCOTT	SCHEMATIC
SEPTEMBER 2014	SCOTT	LOT LAYOUT CHANGE
SEPTEMBER 2014	SCOTT	LOT LAYOUT CHANGE
OCTOBER 2014	SCOTT	UPDATES
MARCH 2015	SCOTT	FINAL DESIGN
OCTOBER 2017	SCOTT	FINAL DESIGN